

Specification

Nominal Voltage	12V
Watts(15min Rate)	221.2 Watte at 1.67V/cell
Dimension	Length 348±3mm (13.7 inches)
	Width 167±2mm (6.57 inches)
	Container Height 178±2mm (7.01 inches)
	Total Height (with Terminal) 178±2mm (7.01 inches)
Approx Weight	Approx 21.2 kg (46.7lbs)
Terminal	T6
Container Material	ABS
Rated Capacity	67.4 AH/6.74A (10hr , 1.80V/cell,25°C/77°F)
	65.0 AH/8.13A (8hr,1.80V/cell,25°C/77°F)
	55.5 AH/11.1A (5hr,1.75V/cell,25°C/77°F)
	49.8 AH/16.6A (3hr,1.75V/cell,25°C/77°F)
	41.8 AH/41.8A (1hr,1.60V/cell,25°C/77°F)
Max. Discharge Current	780A (5s)
Internal Resistance	Approx 7.3mΩ
Operating Temp.Range	Discharge : -15~50°C (5~122°F)
	Charge : 0~40°C (32~104°F)
	Storage : -15~40°C (5~104°F)
Nominal Operating Temp. Range	25±3°C (77±5°F)
Cycle Use	Initial Charging Current less than19.5A.Voltage 14.4V~15.0V at 25°C(77°F)Temp. Coefficient -30mV/°C
Standby Use	No limit on Initial Charging Current Voltage 13.5V~13.8V at 25°C(77°F)Temp. Coefficient -20mV/°C
Capacity affected by Temperature	40°C (104°F) 103%
	25°C (77°F) 100%
	0°C (32°F) 86%
Self Discharge	CT series batteries may be stored for up to 6 months at 25°C(77°F) and then a freshening charge is required. For higher temperatures the time interval will be shorter.



Applications

- ◆ UPS (High rate)
- ◆ High power backup supply
- ◆ Emergency power supply
- ◆ Starting system
- ◆ Power tools
- ◆ Emergency lighting
- ◆ Electric starting

Constant Current Discharge (Amperes) at 25 °C (77°F)

F.V/Time	5min	10min	15min	20min	30min	45min	1h	2h	3h	4h	5h	6h	8h	10h	20h
1.85V/cell	141.6	105.7	90.0	76.6	57.5	42.7	34.6	20.9	15.6	12.5	10.5	9.10	7.70	6.40	3.43
1.80V/cell	175.5	125.2	101.9	84.2	62.0	45.5	36.7	21.9	16.1	12.9	10.8	9.46	8.13	6.74	3.54
1.75V/cell	195.8	136.1	108.7	88.7	65.0	47.6	38.3	22.6	16.6	13.3	11.1	9.7	8.26	6.83	3.60
1.70V/cell	211.4	146.6	114.9	92.8	67.1	49.4	39.5	23.2	17.0	13.6	11.3	9.9	8.39	6.90	3.65
1.67V/cell	226.2	153.7	119.6	96.3	69.4	51.0	40.7	24.0	17.4	13.9	11.6	10.2	8.48	6.98	3.68
1.60V/cell	240.2	161.9	124.0	99.5	71.8	52.3	41.8	24.5	17.8	14.2	11.8	10.4	8.56	7.05	3.71

Constant Power Discharge (Watts/cell) at 25 °C (77°F)

F.V/Time	5min	10min	15min	20min	30min	45min	1h	2h	3h	4h	5h	6h	8h	10h	20h
1.85V/cell	262.9	198.5	170.7	146.6	110.6	82.8	67.6	41.0	30.8	24.9	20.9	18.2	15.5	12.9	6.91
1.80V/cell	322.9	233.3	192.2	160.4	119.0	87.9	71.4	42.8	31.8	25.5	21.5	18.9	16.3	13.5	7.12
1.75V/cell	356.3	251.8	203.8	168.1	124.2	91.6	74.2	44.2	32.6	26.2	21.9	19.3	16.5	13.7	7.21
1.70V/cell	380.5	268.7	214.2	174.9	127.6	94.8	76.3	45.2	33.3	26.7	22.4	19.7	16.7	13.8	7.29
1.67V/cell	402.6	279.1	221.2	180.4	131.3	97.3	78.3	46.5	34.1	27.3	22.9	20.1	16.8	13.9	7.33
1.60V/cell	420.4	290.3	227.0	184.8	134.9	99.5	80.2	47.4	34.7	27.7	23.3	20.5	16.9	14.0	7.38

Specifications subject to change without notice.



Dimensions

T6 Terminal

Unit: mm [inches]

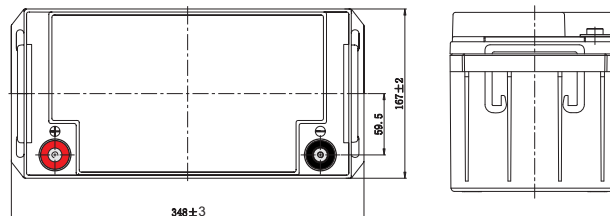
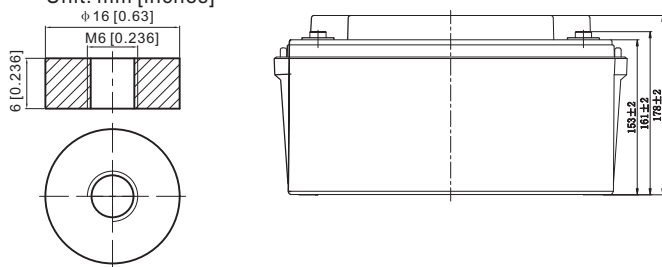

Discharge Characteristics

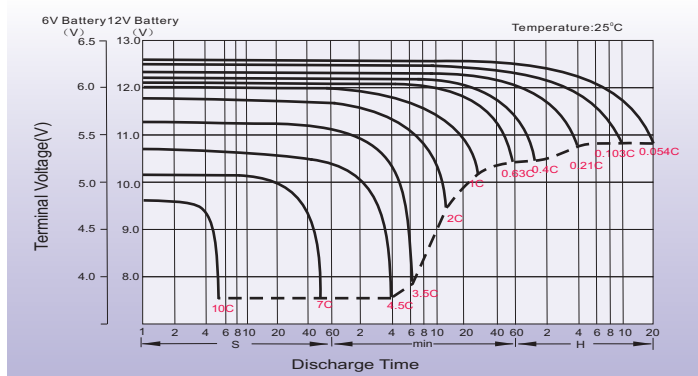

Float Charging Characteristics

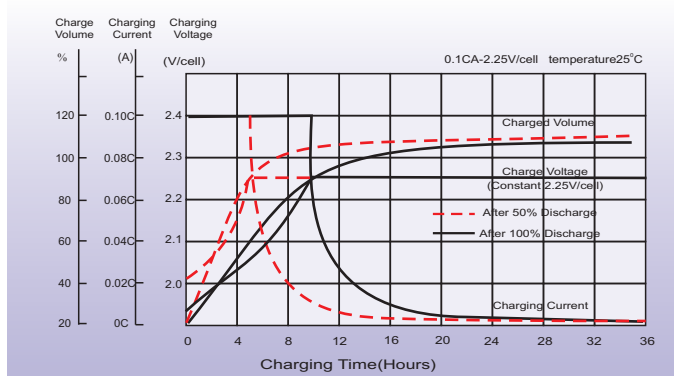

Temperature Effects in Relation to Battery Capacity

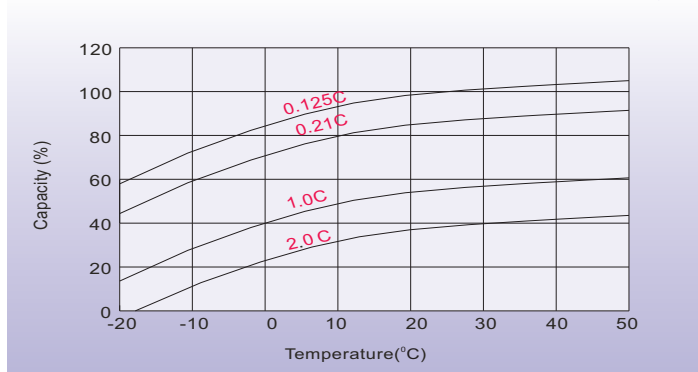

Effect of Temperature on Long Term Float Life

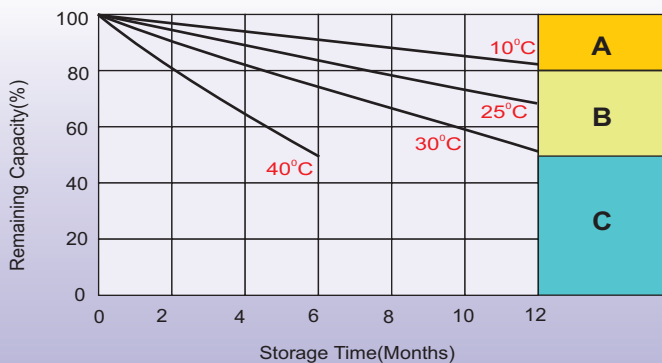
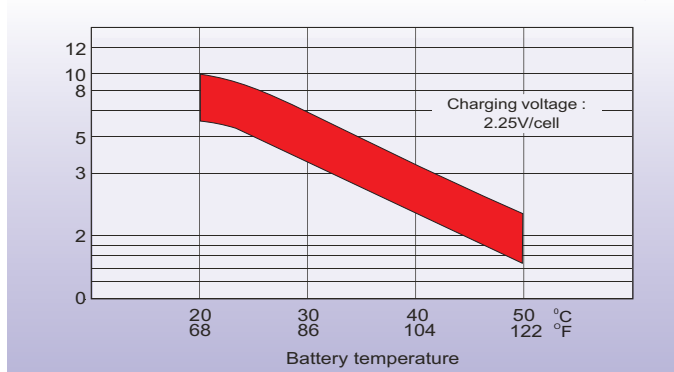

Self Discharge Characteristics

- A** No supplementary charge required
(Carry out supplementary charge before use if 100% capacity is required.)
- B** Supplementary charge required before use. Optional charging way as below:
 1. Charged for above 3 days at limited current 0.25CA and constant voltage 2.25V/cell.
 2. Charged for above 20 hours at limited current 0.25CA and constant voltage 2.45V/cell.
 3. Charged for 8-10 hours at limited current 0.05CA.
- C** Supplementary charge may often fail to recover the capacity.
The battery should never be left standing till this is reached.

Sales Office

Sweden

Cell tech AB,
Äggelundavägen 2, 175 12 Järfälla, Sweden
TEL: +41 8 445 7870
FAX: +41 8 445 7878
E-mail: order@celltech.se
www.celltech.se

Finland and Baltic countries

Celltech oy
Höyläämötie 11A, 00380 Helsinki, Finland
TEL: +358 (0)207 999 1 40
FAX: +358 (0)207 999 1 41
E-mail: info@celltech.fi
www.celltech.fi

Denmark

Celliech A/S
Lejrvej 25, 3500 Værløse Denmark
TEL: +45 7025 2201
FAX: +45 7025 2202
E-mail: info@celliech.dk
www.celliech.dk