

**battery type:** Lithium - Iron Disulfide  
**battery size:** IEC: FR6; ANSI: AA; L91; Mignon  
**chemical system:** Li-FeS<sub>2</sub>

**Conditions**

**nominal voltage:** 1.5 V  
**open circuit voltage:** 1.79...1.89 V new battery  
 1.75...1.89 V after 1 year storage at 20°C

**capacity rated:** 3000 mAh all measurements at 20°C ambient discharge at 75ohms load; 24hours/day End Voltage (EV): 0.9V  
**minimum:** 2800 mAh discharge at 35mA constant current End Voltage (EV): 0.9V  
 2700 mAh discharge at 1000mA constant current End Voltage (EV): 0.8V

**typical service output (new batteries)**

≥ 900 cycles discharge at 1000mA; EV: 0.9V discharge 10s/m 1h/d  
 ≥ 79 h load resistor: 43ohms; EV: 0.9V discharge 4h/d  
 ≥ 160 min discharge at 1000mA; EV: 0.9V discharge 24h/d  
 ≥ 19 h load resistor: 10ohms; EV: 0.9V discharge 24h/d  
 ≥ 11.2 h discharge at 250mA; EV: 0.9V discharge 1h/d

**internal resistance:** ≤ 0.25 Ω at 1kHz, sine wave measurement according to IEC 896-2

**shelf life:** 10 years under proper storage conditions

**leakage resistance**

over discharge: no leakage 10ohms continuous discharge for 48h; ta: 20°C; RH: 60±15%  
 high temperature: no leakage store 20days at ta: 60°C; RH:90±5%

**ambient temperature range:** - 40...60 °C

recommended storage conditions: -20....40 °C ambient temperature  
 45...75 % rel. humidity

**mechanical specifications**

cell dimensions  
 diameter d1: 14.3 - 0.5 mm  
 diameter d2: 5.4 - 0.7 mm  
 height h1: 50.4 - 0.5 mm  
 height h2: 1.7 - 0.5 mm  
 weight: 15 ± 2 g

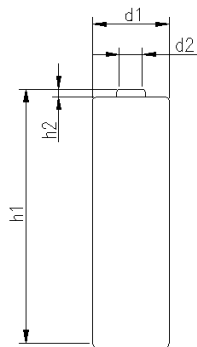

blister card dimensions: 85 x 120 mm  
 weight (incl. batteries): 73 ± 4 g

approvals: UL 1642 tested

	<b>ANSMANN Specifications for model:</b>	<b>Ansmann Lithium Battery</b>
		<b>AA - size 4pcs blister</b>
	data sheet no. / part no.	1512-0002
	Version no.	
	author / date	Gramlich / 01.12.2010